

THIS DRAWING IS THE PROPERTY OF PRIMARY FLUID SYSTEMS INC. FROM WHICH A WRITTEN CONSENT FOR APPROVAL SHALL BE REQUIRED PRIOR TO COPYING.

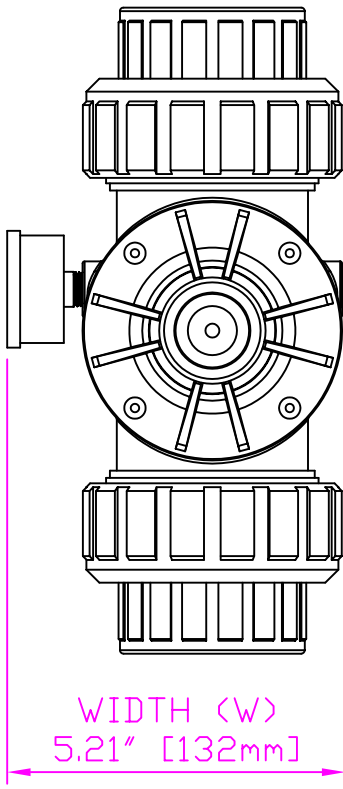

WIDTH (W)
5.21" [132mm]

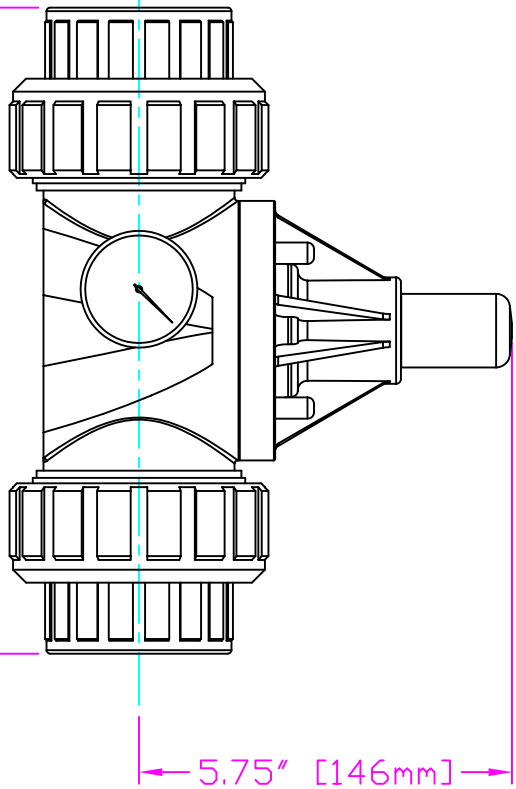

9.96" [253mm]
LENGTH (L)

5.75" [146mm]
HEIGHT (H)

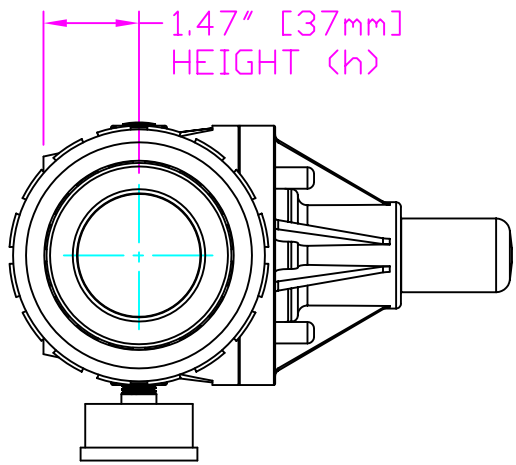
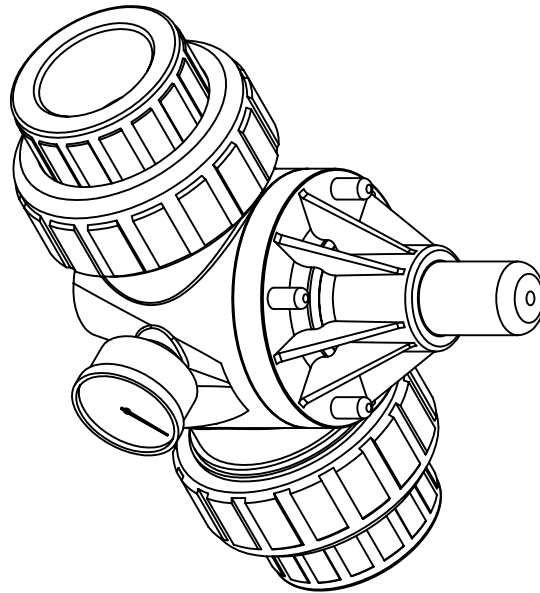

1.47" [37mm]
HEIGHT (h)

- THIS DRAWING WITH DIMENSIONS APPLY TO FOLLOWING MODELS:
- ECD-1501-PVC-P-GAUGE
 - ECD-1501-CPVC-T-GAUGE
 - ECD-1501-PP-T-GAUGE
 - ECD-1501-PVDF-T-GAUGE
 - ECD-150J-PVC-P-GAUGE
 - ECD-150J-CPVC-T-GAUGE
 - ECD-150J-PP-T-GAUGE
 - ECD-150J-PVDF-T-GAUGE

PRIMARY FLUID SYSTEMS INC.

1050 Cooke Blvd, Burlington, Ontario L7T 4A8

UNION X 1/2" (DN 40) SOCKETED
ECD VALVE
WITH GAUGE

PROJECT: C-SERIES ECD		SHT. 1 OF 1	DRAWN BY: VICTOR V.L.
DATE ISSUED: 23-NOV-11		SCALE: 1:3	UNITS: INCHES
ECO-1501-PVC-P-GAUGE-2D			
MATERIAL: PLY			
APPROVED BY:			
DIMENSIONAL TOLERANCE XXX = ± 0.25"			
REVISION #			
SHEET		8.5 X 11	
SIZE:			

DWG TYPE: PLANAR VIEW 2D

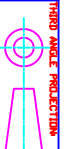

THIRD ANGLE PROJECTION