

THIS DRAWING IS THE PROPERTY OF PRIMARY FLUID SYSTEMS INC. FROM WHICH A WRITTEN CONSENT FOR APPROVAL SHALL BE REQUIRED PRIOR TO COPYING.

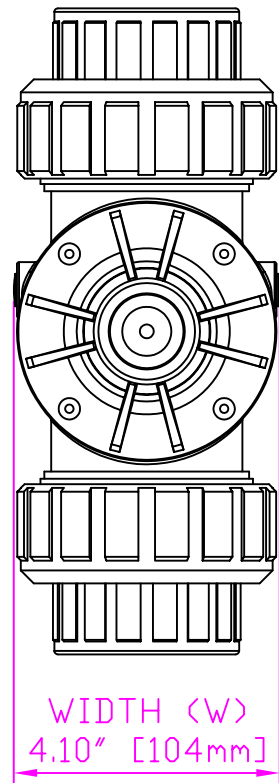

WIDTH (W)
4.10" [104mm]

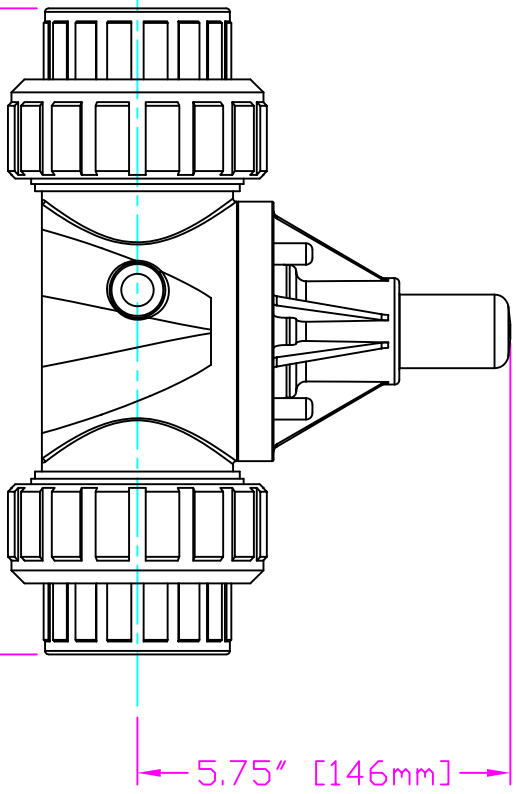

9.96" [253mm]
LENGTH (L)

5.75" [146mm]
HEIGHT (H)

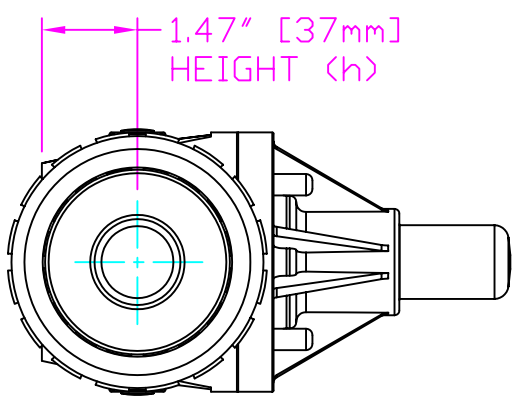
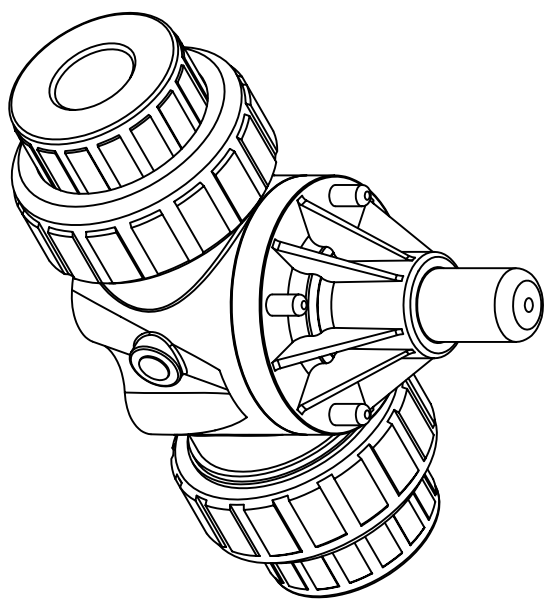

1.47" [37mm]
HEIGHT (h)

- THIS DRAWING WITH DIMENSIONS
APPLY TO FOLLOWING MODELS:
- ECD-110I-PVC-P
 - ECD-110I-CPVC-T
 - ECD-110I-PP-T
 - ECD-110I-PVDF-T
 - ECD-110J-PVC-P
 - ECD-110J-CPVC-T
 - ECD-110J-PP-T
 - ECD-110J-PVDF-T

PRIMARY FLUID SYSTEMS INC.

UNION X 1" (DN 25) SOCKETED
ECD VALVE (HIGH FLOW VERSION)

1050 Cooke Blvd., Burlington, Ontario L7T 4A8

PROJECT: C-SERIES ECD		SHT: 1 OF 1		DRAWN BY: VICTOR W.	
DATE ISSUED: 22-NOV-11		SCALE: 1:3		UNITS: INCHES	
MATERIAL: POLY		ECCO-110I-PVC-P-2D		REV# 0	
APPROVED BY:		HARD ANGLE PROJECTION		DIMENSIONAL TOLERANCE XXX = ± 0.25"	
DVG TYPE: PLANAR VIEW 2D		SHEET SIZE: 8.5 X 11		SHEET NO: 1	

A