

THIS DRAWING IS THE PROPERTY OF PRIMARY FLUID SYSTEMS INC. FROM WHICH A WRITTEN CONSENT FOR APPROVAL SHALL BE REQUIRED PRIOR TO COPYING.

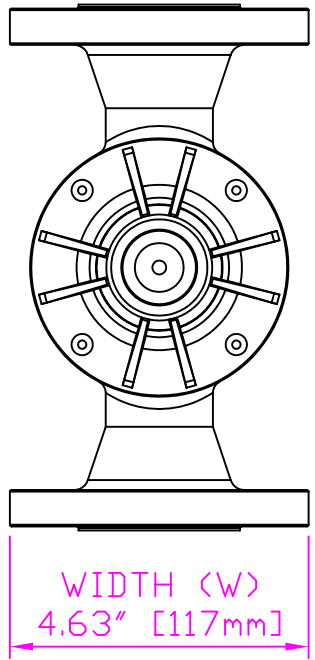

WIDTH (W)
4.63" [117mm]

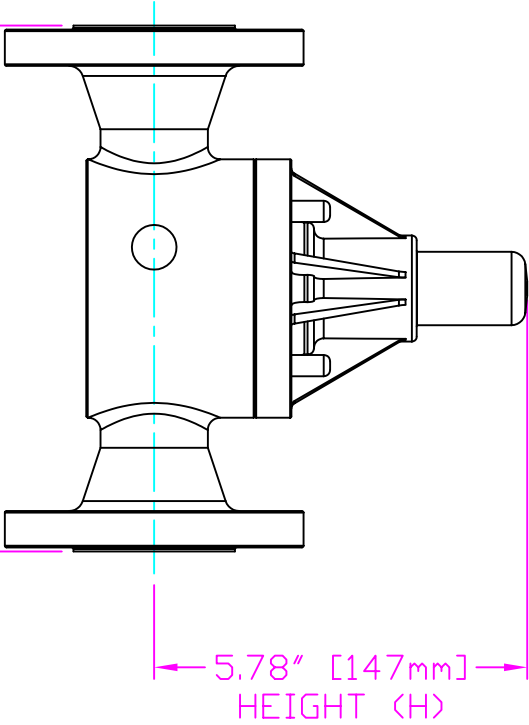
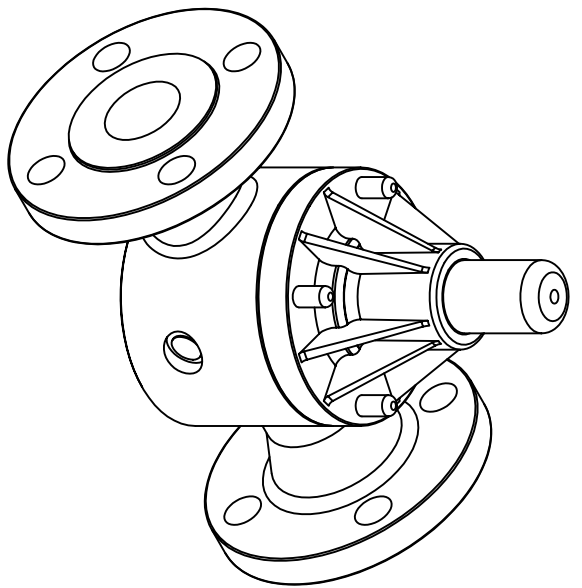

8.14" [207mm]
LENGTH (L)

5.78" [147mm]
HEIGHT (H)

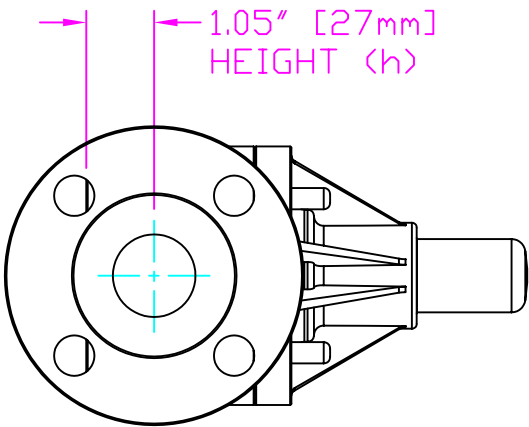

1.05" [27mm]
HEIGHT (h)

THIS DRAWING WITH DIMENSIONS
APPLY TO FOLLOWING MODELS:

- ECD-125E-SS-T
- ECD-125E-ALL20-T
- ECD-125E-HAST-T
- ECD-125F-SS-T
- ECD-125F-ALL20-T
- ECD-125F-HAST-T

PRIMARY FLUID SYSTEMS INC.

1050 Cooke Blvd, Burlington, Ontario L7T 4A8

1 1/2" (DN 32) FLANGED
ECD VALVE

PROJECT: C-SERIES ECD
DATE ISSUED: 13-DEC-11
ECC-125E-SS-T-2D

SHT: 1 OF 1
SCALE: 1:3
MATERIAL: METALLIC

DRAWN BY: VICTOR V.L.

UNITS: INCHES

DWG TYPE:

PLANAR VIEW, 2D

APPROVED BY:



THIRD ANGLE PROJECTION

REV.#: 0

SHEET: 05 X 11
SIZE: A

DIMENSIONAL TOLERANCE
XXX = ± 0.25"