

THIS DRAWING IS THE PROPERTY OF PRIMARY FLUID SYSTEMS INC. FROM WHICH A WRITTEN CONSENT FOR APPROVAL SHALL BE REQUIRED PRIOR TO COPYING.

NO.	NAME	DESCRIPTION
1	MAX ALLOWABLE OPERATING TEMPERATURE	260°F (125°C)
2	MAX ALLOWABLE OPERATING PRESSURE	150 PSIG
CONNECTIONS		
3	INLET PORT CONNECTION	2"
4	OUTLET PORT CONNECTION	2"
MATERIALS		
5	TYPE	NPT
6	BODY, QUILL AND CHECK SEAT	PVDF
7	GLAND	PVDF
8	GLAND SEAL	VITON (EPDM OPTIONAL)
9	VALVE ASSEMBLY	PVDF

CS CORPORATION STOPS

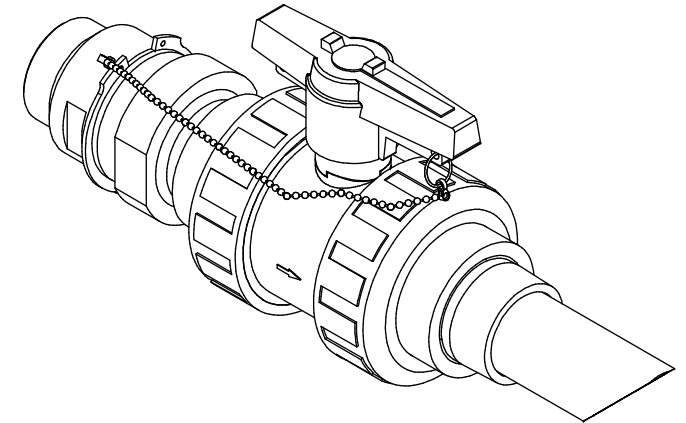
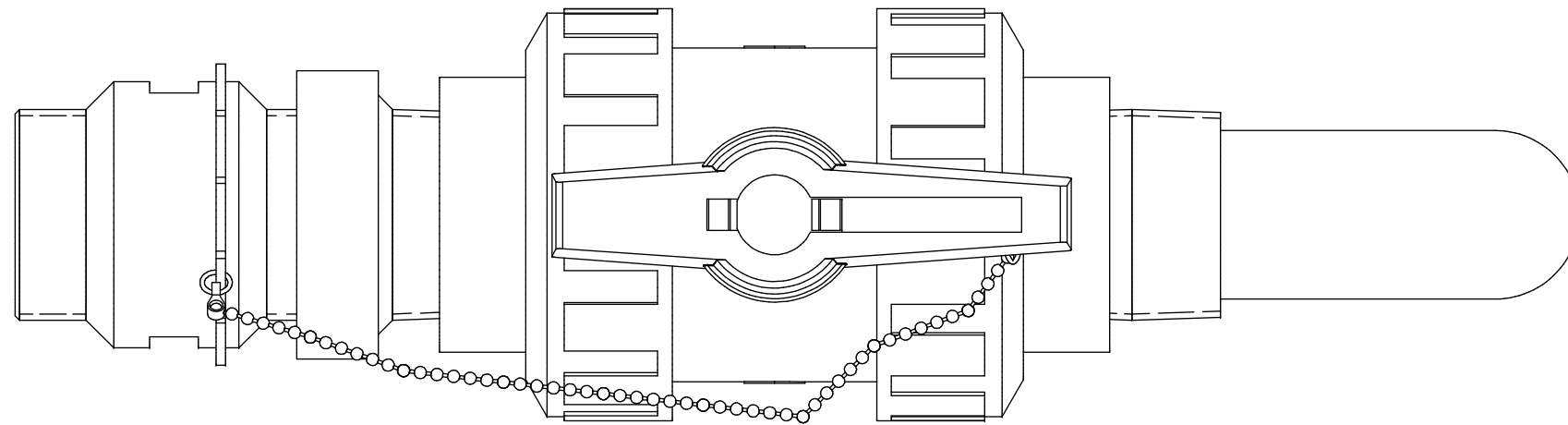

SCALE 1 : 4

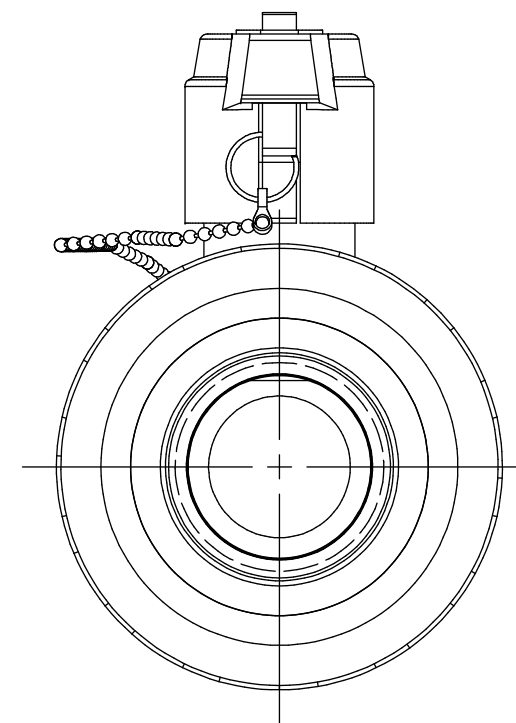
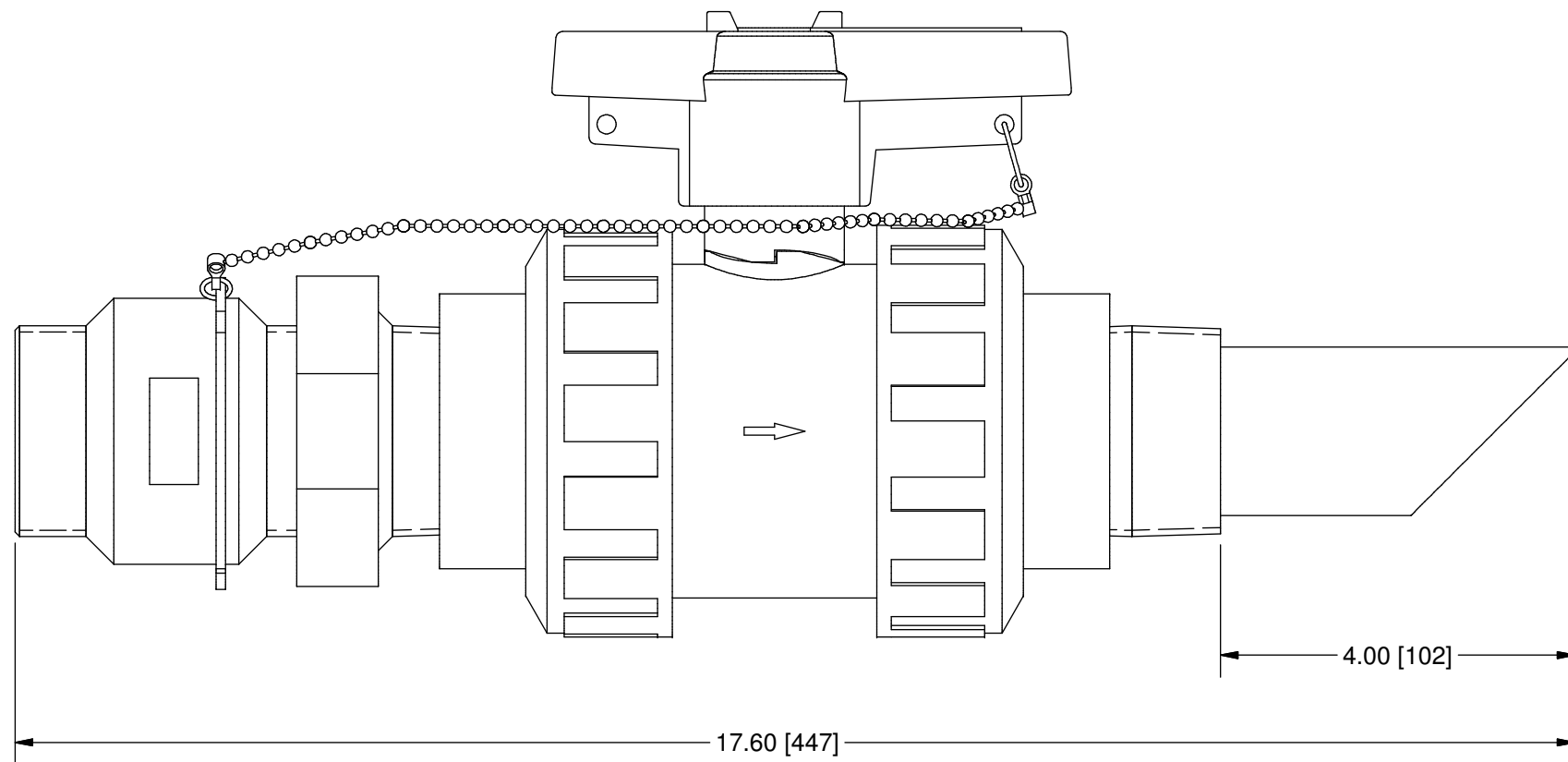

OPTION STINGER TIP (4IB)
SCALE 1 : 2

PRIMARY FLUID SYSTEMS INC. 1050 COOKE BLVD, BURLINGTON, ONTARIO L7T 4A8		PROJECT: CS	SHT: 1 OF 1	DRAWN BY: BL
TITLE: CORP STOP WITH 2" INLET AND 2" OUTLET NPT CONNECTIONS		DATE DRAWN: 8/27/2024	SCALE: 1 : 2	UNITS: INCH [mm]
DWG NO: CS-20A20A-41A-DDDV_R0		MATERIAL: SEE CHART		REV# 0
DWG NAME: CORP STOP		APPROVED BY: CHECKED BY:		THIRD ANGLE PROJECTION
DWG TYPE: PLANAR VIEW		DIMENSIONAL TOLERANCE 0.X = ± 0.25" 0.XX = ± 0.25" 0.XXX = ± 0.25"		11 X 17 SHEET SIZE: B

REV	DESCRIPTION	DATE	NAME
0	NEW DRAWING	--	--

REVISION HISTORY