

THIS DRAWING IS THE PROPERTY OF PRIMARY FLUID SYSTEMS INC. FROM WHICH A WRITTEN CONSENT FOR APPROVAL SHALL BE REQUIRED PRIOR TO COPYING.

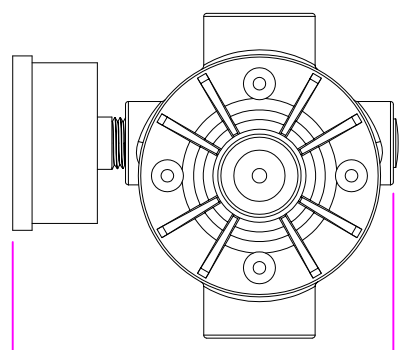

3.93" [100mm]  
WIDTH

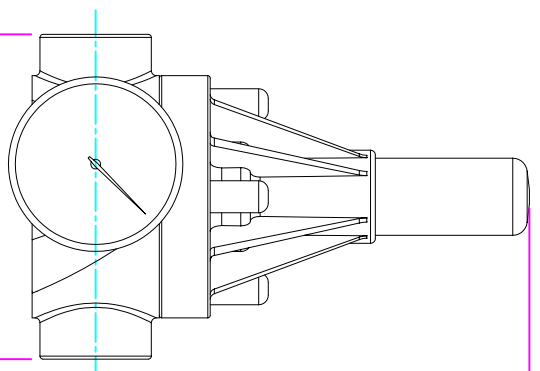

LENGTH (L)  
3.40" [86mm]

4.48" [114mm]  
HEIGHT (H)

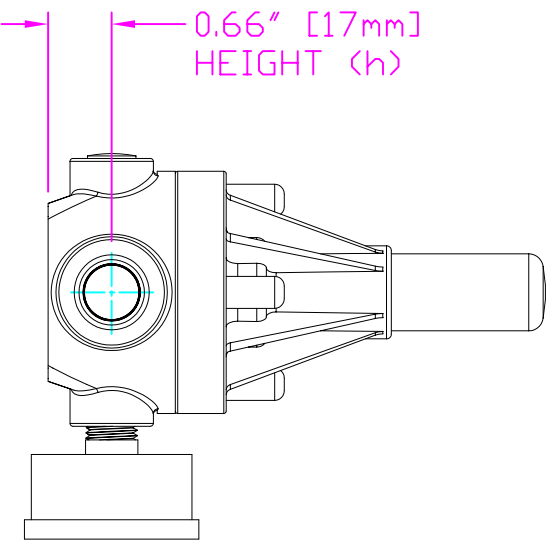
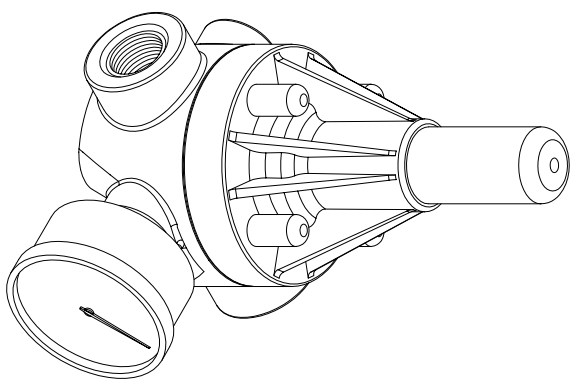

0.66" [17mm]  
HEIGHT (h)

**PRIMARY FLUID SYSTEMS INC.**

1050 Cooke Blvd., Burlington, Ontario L7T 4A8

**ECD VALVE WITH 3/8" BSPT FEMALE & GAUGE**

DWG NAME: 0.375" BSPT FEMALE  
 DWG TYPE: PLANAR VIEW 2-D

PROJECT: A-SERIES ECD  
 DATE ISSUED: 26-JUL-10  
 ECD-38B-PVC-P-GAUGE-2D

SHT: 1 OF 1  
 SCALE: 1:2  
 MATERIAL: POLY

DRAWN BY: VICTOR V.  
 UNITS: INCHES  
 DIMENSIONAL TOLERANCE: XXX = ± 0.25"

APPROVED BY: [Signature]



REV: # 0  
 SHEET SIZE: 8.5 X 11  
**A**