

THIS DRAWING IS THE PROPERTY OF PRIMARY FLUID SYSTEMS INC. FROM WHICH A WRITTEN CONSENT FOR APPROVAL SHALL BE REQUIRED PRIOR TO COPYING.

NO.	NAME	DESCRIPTION
1	MAX ALLOWABLE OPERATING TEMPERATURE	140°F (60°C)
2	MAX ALLOWABLE OPERATING PRESSURE	15 PSIG
3	LEAK TEST	YES
CONNECTIONS	4 BOTTOM PORT CONNECTION	1/2"
5	TOP PORT CONNECTION	DUST CAP
6	TYPE	NPT
MATERIALS	7 CYLINDER	POLYPROPYLENE
8	END CAPS	POLYPROPYLENE
INPUT DATA	12 VOLUME SIZE	1000 ML
SCALE	13 GRADUATION	10 ML
COMMENTS	15 ALL CYLINDERS ARE RATED FOR LIQUID SERVICE ONLY	✓
16	CYLINDERS ARE NOT PRESSURE VESSELS	✓

## CLEARVIEW® PP#3 POLYPROPYLENE CALIBRATION CYLINDER

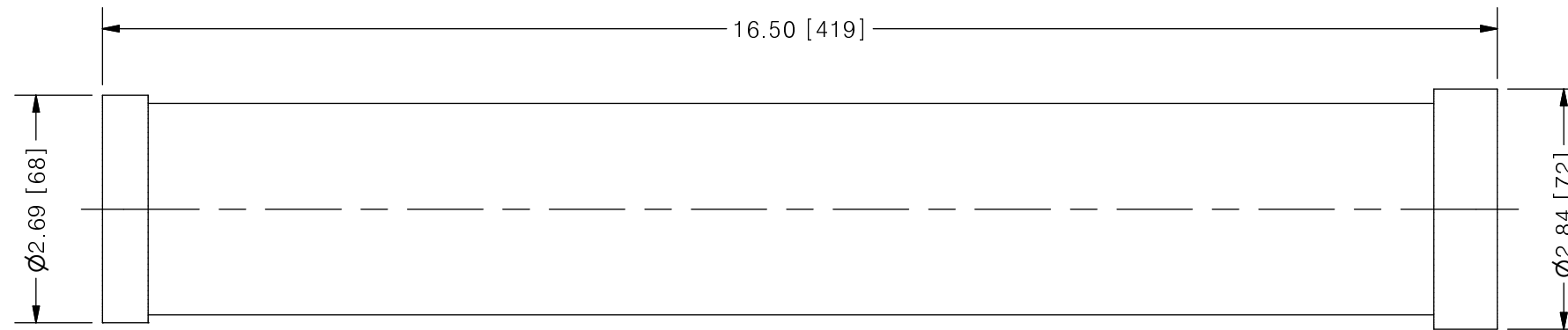
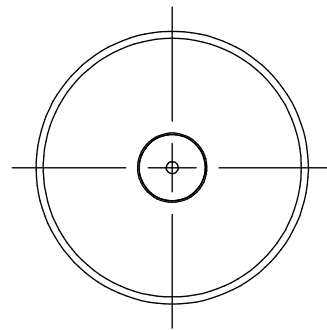

SCALE 1 : 2

REV	DESCRIPTION	DATE	NAME
0	NEW DRAWING	--	--

REVISION HISTORY

<b>PRIMARY FLUID SYSTEMS INC.</b> 1050 COOKE BLVD, BURLINGTON, ONTARIO L7T 4A8	PROJECT: PP	SHT: 1 OF 1	DRAWN BY: NG
	DATE DRAWN: 5/25/2016	SCALE: 1 : 2	UNITS: INCH [mm]
TITLE: 1000 ML CALIBRATION CYLINDER WITH 1/2" NPT CONNECTION	MATERIAL: SEE CHART	DWG NO: PP#3-1000_R0	REV# 0
DWG NAME: PP CYLINDER	APPROVED BY:	CHECKED BY:	DIMENSIONAL TOLERANCE 0.X = ± 0.25" 0.XX = ± 0.25" 0.XXX = ± 0.25"
DWG TYPE: PLANAR VIEW			