

ITEM	MODEL	PART#	DESCRIPTION	MATERIAL
1	API/APIF	1010-28-^	WETTED HOUSING	PVC
		P1000-28-^	WETTED HOUSING	GF POLYPROPYLENE
		K1000-28-^	WETTED HOUSING	PVDF
2	API/APIF	1000-25	BLADDER	NEOPRENE
		1000-28	BLADDER	EPDM
		1000-29	BLADDER	BUNA-N
		1000-30	BLADDER	HYPALON
		1000-31	BLADDER	VITON
		1000-55	BLADDER	AFLAS
		P1000-10*	BLADDER (PVC & PP)	TEFLON
		K1000-10*	BLADDER (PVDF)	TEFLON
3A	API	1010-24	NONWETTED HOUSING	PVC
		P1000-24	NONWETTED HOUSING	GF POLYPROPYLENE
		K1000-24	NONWETTED HOUSING	PVDF
3B	APIF	1010-33	NONWETTED HOUSING	PVC
		1000-33	NONWETTED HOUSING	GF POLYPROPYLENE
		1060-33	NONWETTED HOUSING	PVDF
4	API/APIF	101-20	GAUGE	PLASTIC/BRASS
5	API/APIF	1000-46	TEE	STEEL
6	API/APIF	1000-70	FILL VALVE	BRASS
7	API/APIF	1000-43	FASTENER ASSEMBLY	S/S (SET OF 6)
8	APIF	1000-42	BUSHING	GALVANIZED STEEL
9	API/APIF	P1000-G**	O'RING ASSY PVC&PP UNITS	TFE ENCAPSULATED VITON
	API/APIF	K1000-G**	O'RING ASSY PVDF UNITS	VITON / PTFE TAPE
10	API/APIF	1000-58***	CHARGEABLE AIR ASSY	PLASTIC/BRASS/S/S

^ ADD SUFFIX - 0 FOR UNITS WITH 3/8" CONNECTIONS  
 ADD SUFFIX - 1 FOR UNITS WITH 1/2" CONNECTIONS  
 \* INCLUDES ITEM 9  
 \*\* ONLY USED WITH TEFLON BLADDERS  
 \*\*\* INCLUDES ITEM 4, 5, AND 6  
 GF = GLASS FILLED

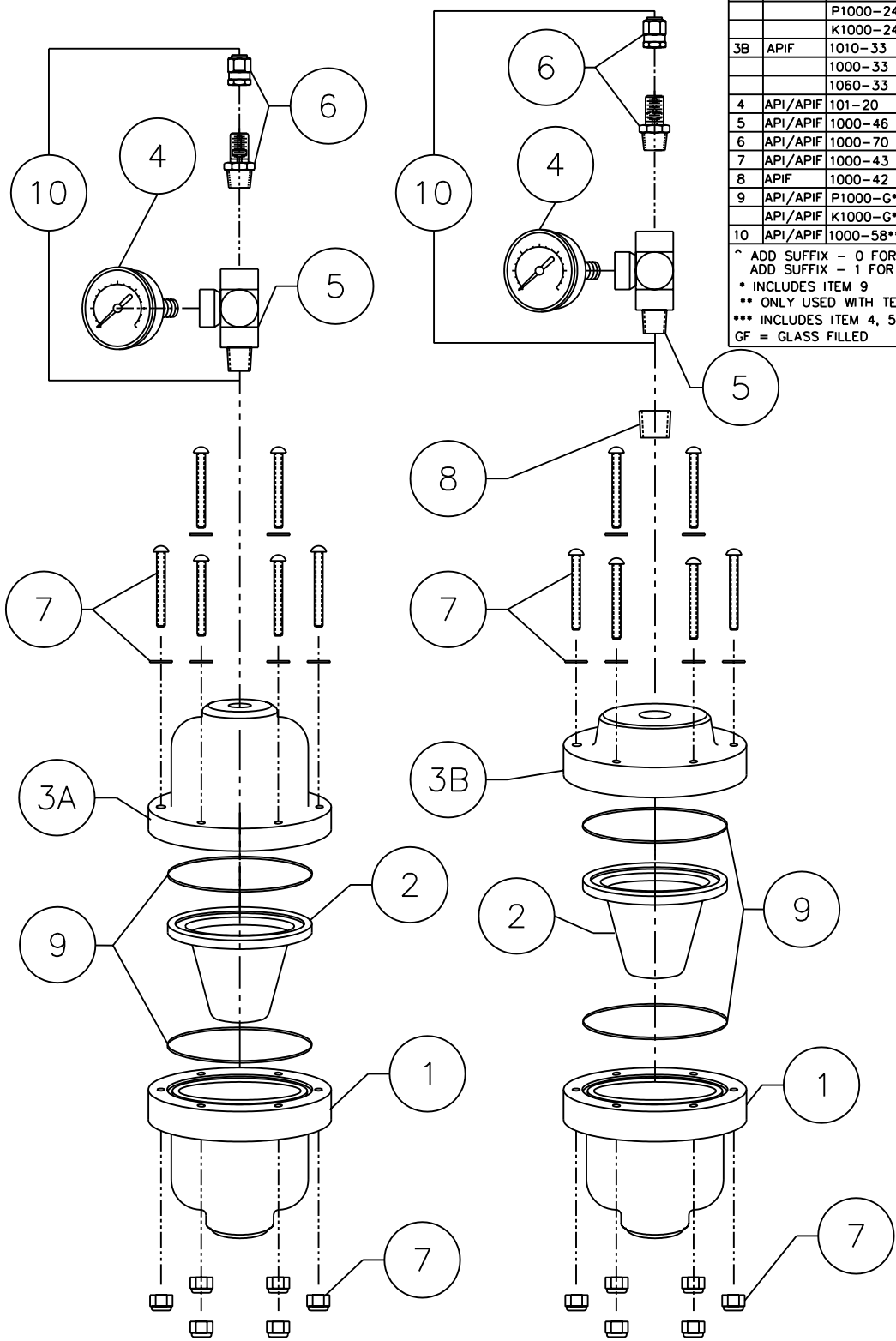

DO NOT COPY WITHOUT PRIOR WRITTEN APPROVAL FROM PRIMARY FLUID SYSTEMS. ACCEPTABILITY OF SPECIFICATIONS ARE THE CLIENT'S RESPONSIBILITY.

**Primary Fluid Systems Inc.**

ACCUPULSE PULSATION DAMPENER - API/APIF Series  
 THERMOPLASTIC EXPLODED PARTS VIEW

SCALE	NTS	DISC	DRAWN BY	BRB
DATE	05 03 16	APPROVED	DWG NO.	
PROJECT			API/APIF-PLASTIC-Exploded	REV.# 1